

CERAMIC & QUARTZ GRINDING MACHINE

DNC 8050 · 8060

8/40 tool ATC

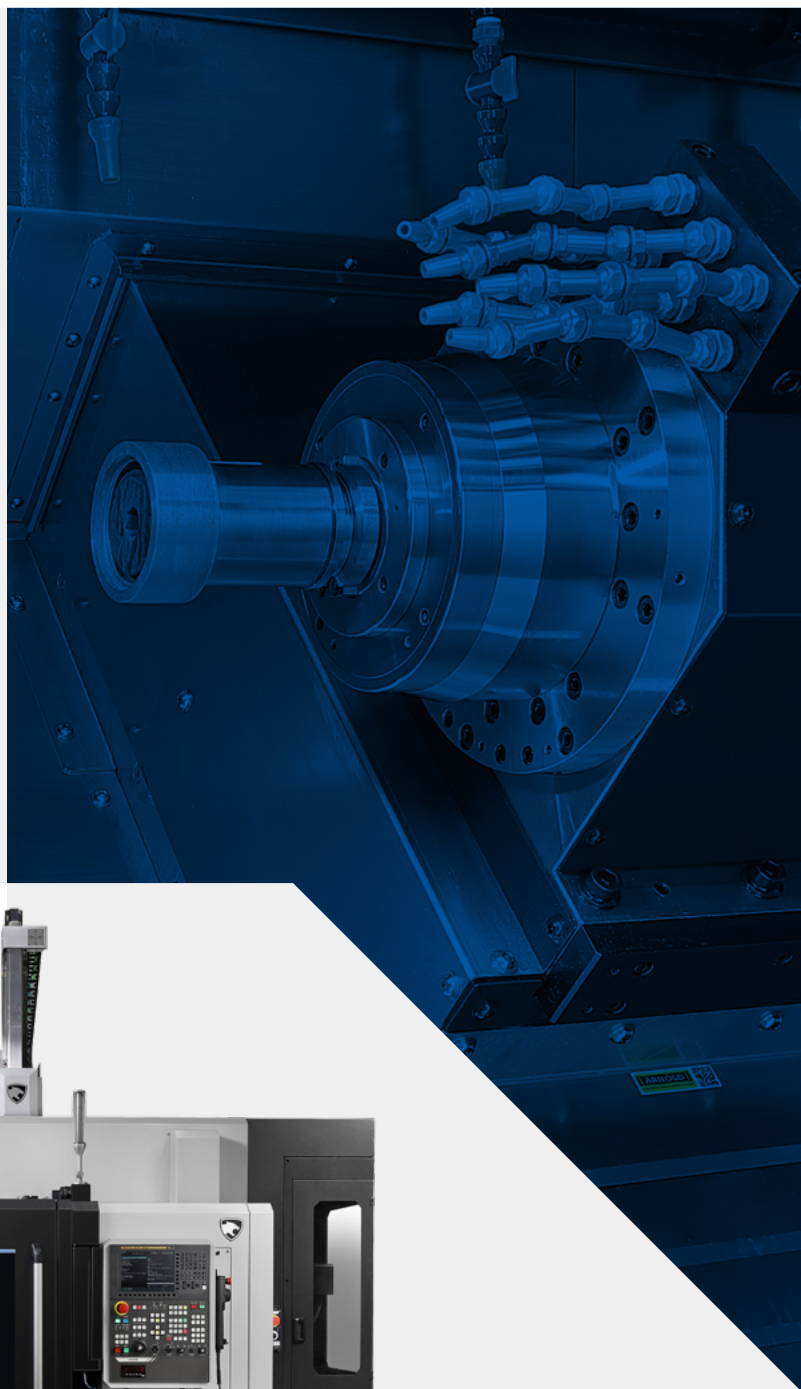

BASIC STRUCTURE

Reduced vibration and minimized thermal displacement achieved through the integration of a highly stiff bed structure and a highly stable feed shaft guide.

- Supporting the X-axis feed that moves the grinding spindle through a wide rail gap between the Z-axis upper and lower rail
- Increased machine stability by adapting all-in-one bed structure

Rapid traverse

X/Z-axis **10/20** m/min
393.7 / 787.4 ipm

Feeding system

X/Z-axis
BOX GUIDE

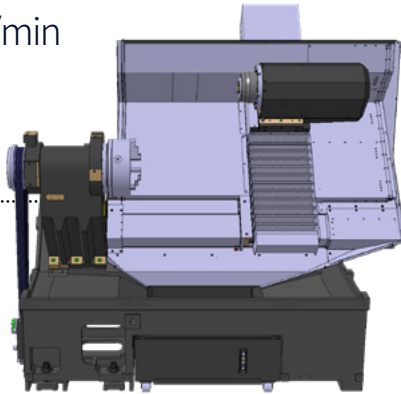

MACHINING AREA

With a max. machining diameter of Ø810mm and a max. distance of 610mm between the chuck and grinding spindle, sufficient space has been made available for workpiece and tool setting.

Max. Machining Dia.

810 mm 31.9 inch

Max. Distance between chuck and grinding spindle

610 mm 24.0 inch

From chuck face to spindle gauge line Except Jaw height and tool length

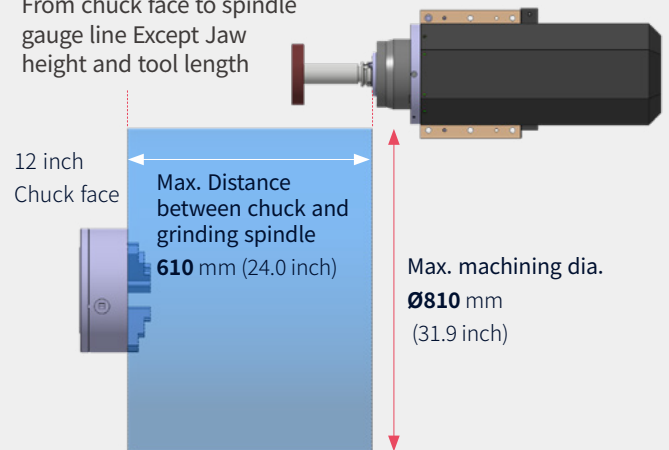

MAIN SPINDLE

Rotates workpiece stably, able to equip various chucks. Coolant protection structure makes high rigidity and high rotational precision is achieved via the incorporation of preloaded bearings.

Vacuum chuck preparation OPTION

Max. spindle speed

500 r/min

Spindle nose

A2-8

Various chucks equipable

12~20 inch

- Applying 20 inch chuck
- BP30 spindle motor
- if more precise profile machining is necessary, built-in motor spindle option is required.

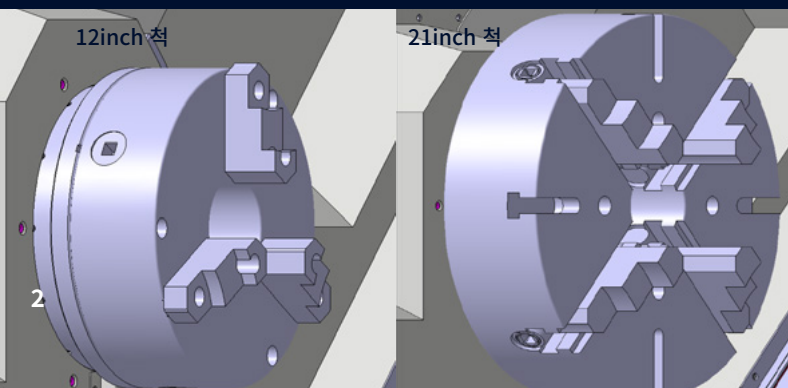

BUILT-IN MOTOR GRINDING SPINDLE

Premium quality grinding spindle designed by DN Solutions and reliable Fanuc Built-in motor inside, can handle various material machining like Quartz, Si, SiC, Ceramic etc., TSC(Through Spindle Coolant) can be chosen as option.

Max. spindle speed

10000 r/min

Max. Motor Power

7.5 kW 10.1 Hp

Tool specification

BT40 Big Plus

{CAT40 Big Plus}

TSC (Through Spindle Coolant)

- Coolant filtering system(option) must be used together

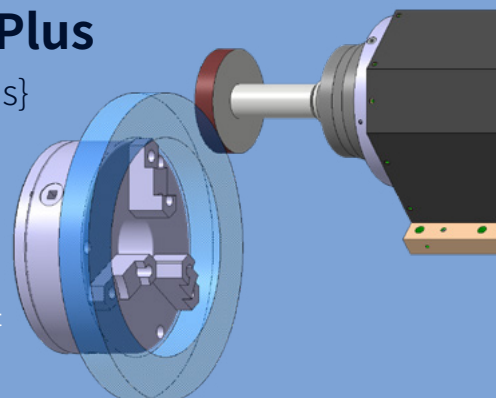

FULL COVER STRUCTURE FOR PROTECTING THE INSIDE OF THE MACHINE

EASY CLEANING COOLANT TANK

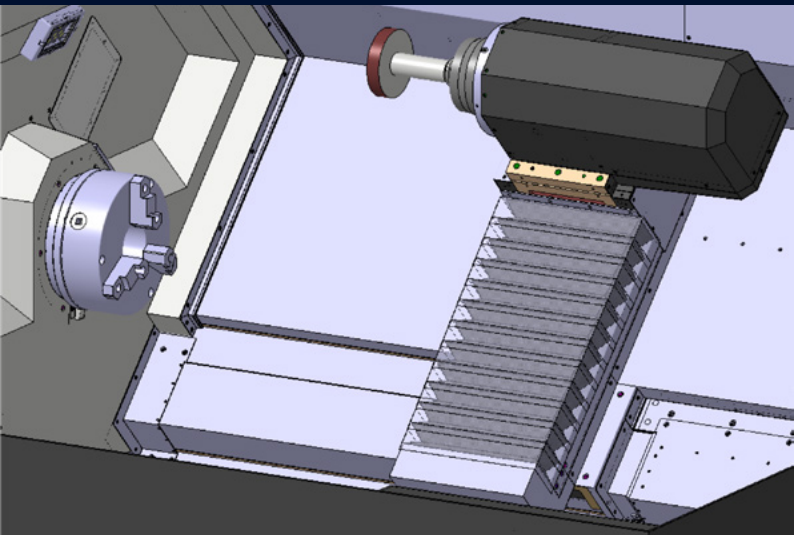

- Sliding cover structure that wraps around the entire slope of the bed prevents coolant and chips from entering the machine.

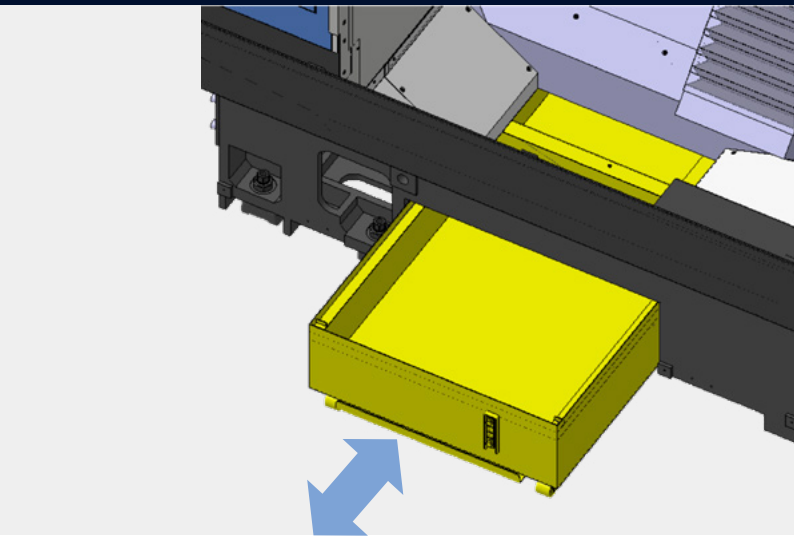

- Coolant tank that can be removed in the forward or backward directions of the machine increases space efficiency
- easy to clean the sludge chip due to no protrusion inside

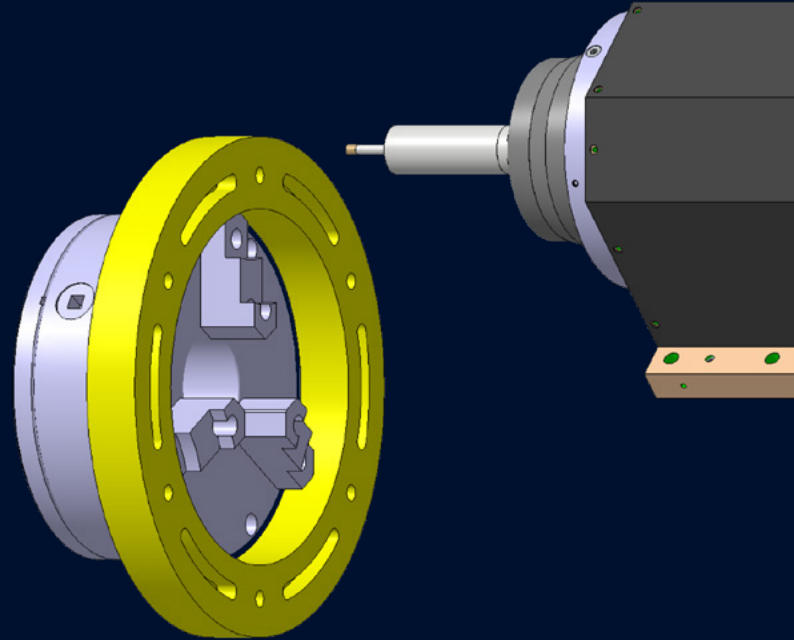

C-axis control and main spindle brake (Standard)

Hole machining and contouring, which have been performed in a separate process by a machining center, are also possible by one setting.

Auto tool changer(ATC) OPTION

Up to 40 tools of BT40/CAT40 can be mounted on the magazine, and the tools are automatically exchanged by ATC.

40-tool magazine		Unit	Specification
Tool Storage Capacity		ea	8/40
Tool Shank type			BT40 {CAT40} Big Plus
Max. tool dia.	With near tool	mm (inch)	75 (29.5)
	Without near tool		152 (6)
Min. tool length			85 (3.35")
Max. tool length			200 (7.87")
Max. tool weight		kg (lb)	8 (17.6)

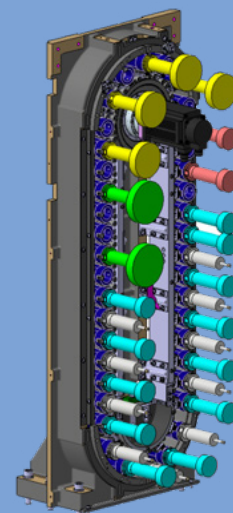

Specification

Item	Unit	DNC 8050	DNC 8050 (8 ATC)	DNC 8060	DNC 8060 (8 ATC)	DNC 8060 (40 ATC)	
Capacity	Chuck Size	mm (inch)	12-20				
	Max. turning dia.	mm (inch)	810 (31.9)				
Carriage	Travel X	mm (inch)	550 (21.7)				
	Travel Z	mm (inch)	550 (21.7)	650 (25.6)			
	Rapid Traverse Rate X	m/min (ipm)	10 (393.7)				
	Rapid Traverse Rate Z	m/min (ipm)	20 (787.4)				
Main Spindle	Drive Mechanism		Belt-Drive		Belt-Drive{Built-in}		
	Spindle speed	r/min	500				
	Spindle nose	ASA	A2-8				
	Spindle power	kW (Hp)	14.1 / 6.3 (β12) {18.5/15 (βp30)} (18.9/8.4 (β12) {24.8/20.1 (βp30)})		18.5/15 (βp30) {14.1 / 6.3 (β12)} (24.8/20.1 (β30) {18.9/8.4 (βp12)})		
Grinding Spindle	Spindle taper	-	BT40{CAT40}				
	Spindle Speed	r/min	10000				
	Spindle power	kW (Hp)	7.5 (10.1)				
Machine Size	Floor Space	mm (inch)	2370{2610} x 2043 (93.3{102.8} x 80.4)	2688{2928} x 2043 (105.8{115.3} x 80.4)	2840{2600} x 2043 (111.8{102.4} x 80.4)	2928{2688} x 2043 (115.3{105.8} x 80.4)	3435{3195} x 2043 (135.2{125.8} x 80.4)
	Height	mm (inch)	2042 (80.4)	3400 (133.9)	2042 (80.4)	3400 (133.9)	3480 (137.0)
	Weight	kg (lb)	3200 (7054.7)	4500 (9920.7)	3400 (7495.6)	4500 (9920.7)	5000 (11023.0)
ATC	Tool Shank		BT40{CAT40}				
	Drive Mechanism		Servo				
	Tool Storage Capacity	ea	-	8	-	8	40
CNC & Motors	CNC Controller		FANUC Oi-TF Plus				

* { } : Option



dn-solutions.com

Head Office

19F, 10, Tongil-ro, Jung-gu, Seoul,
Republic of Korea, 04527

Tel: +82-2-6972-0370

Fax: +82-2-6972-0400

DN Solutions America

360 E State PKWY,
Schaumburg, IL. 60173,
United states

Tel: +1-315-265-7500

DN Solutions Europe

Emdener Strasse 24, D-41540
Dormagen, Germany

Tel: +49-2133-5067-100

Fax: +49-2133-5067-111

DN Solutions India

No.82, Jakkuar Village
Yelahanka Hobil,
Bangalore-560064

Tel: +91-80-2205-6900

E-mail: india@dncompany.com

DN Solutions China

Room 101,201,301,
Building 39 Xinzhuan Highway
No.258 Songjiang District
China Shanghai (201612)

Tel: +86 21-5445-1155

Fax: +86 21-6405-1472

DN Solutions Vietnam

M.O.R.E building 2F, 40A-40B Ut
Tich Street, 04 Ward 04,
District Tan Binh District,
Ho Chi Minh City, Vietnam

Tel: +84 28-7304-0163

DN Solutions Mexico

Avenida Parque Bicentenario
#100 Nave M65L3-6,
Fraccionamiento San Isidro
Business Park,
Santa Rosa Jauregui,
Querétaro, México

E-mail: efrain.figueroa@
dncompany.com

Sales inquiry

sales@dncompany.com